

B204 Strain clamp NX,NUT connector 1 to 10 kV

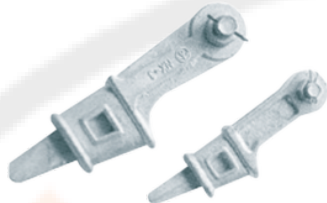

NX

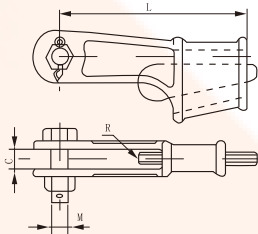

NUT

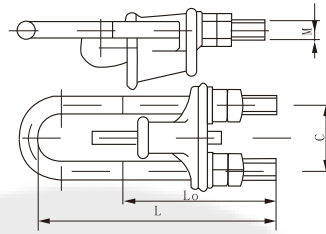

NU

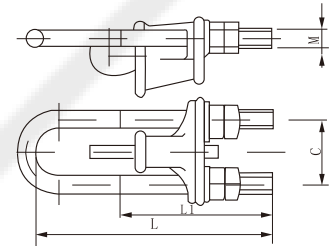

Type	Steel Wire Dia (mm)	Dimensions(mm)				Rated failure load(kN)	Weight (kg)
		C	M	L	L1		
NUT-1	6.6-7.8	56	16	350	200	45	2.10
NUT-2	9.0-11.0	62	18	430	250	88	3.20
NUT-3	13.0-14.0	74	22	500	300	143	5.40
NUT-4	15.0-16.0	82	24	580	300	164	7.20

Type	Steel Wire Dia (mm)	Dimensions(mm)				Rated failure load(kN)	Weight (kg)
		C	M	L	L0		
NU-1	6.6-7.8	56	16	290	70	45	1.92
NU-2	9.0-11.0	62	18	290	70	88	2.61
NU-3	13.0-14.0	74	22	290	60	143	4.21
NU-4	15.0-16.0	82	24	340	70	164	7.27

Type	Steel Wire Dia (mm)	Dimensions(mm)				Rated failure load(kN)	Weight (kg)
		C	M	L	R		
NX-1	6.6-7.8	18	16	150	6.0	45	1.19
NX-2	9.0-11.0	20	18	180	7.3	88	1.76
NX-3	13.0-14.0	24	24	200	7.3	143	3.20
NX-4	15.0-16.0	28	27	220	8.0	164	5.30